

Site at London Road

London Road, Rainham, Gillingham, Kent, ME8 8PT

FOR SALE

2.07 acres



Showroom / Roadside / Alternative Use Development Opportunity (Subject to Planning)



0207 344 6730

colliers.com/uk/industrial

Tim Harding:
Phone: 07860 180 328
Email: tjm.harding@colliers.com

Anthony Keohane:
Phone: 0 7785 253058
Email: anthony.Keohane@colliers.com



Kevin Dempster:
Phone: 01634 668 0000
Email: kevindempster@watsonday.com

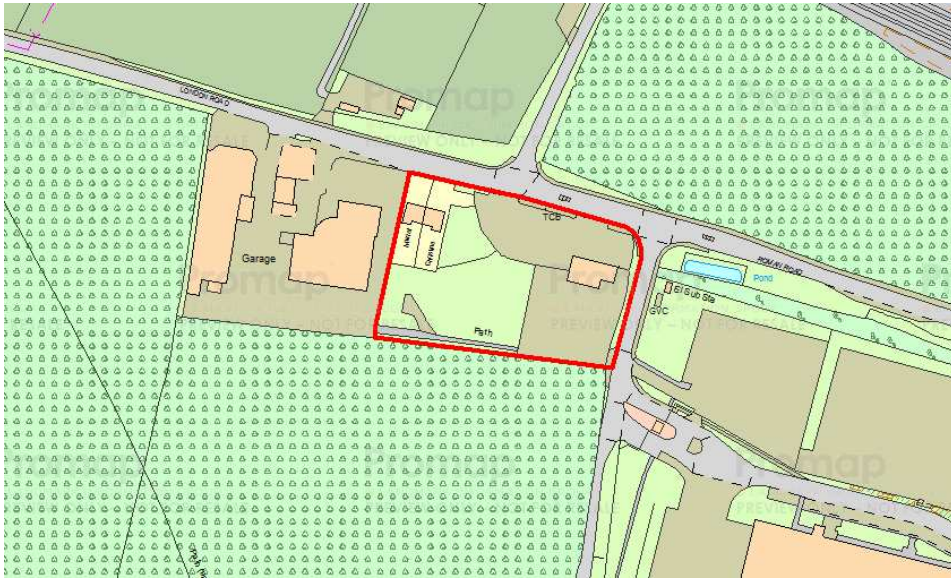

LOCATION

The site is situated directly on the A2 just outside Rainham and close to the towns of Sittingbourne, Rochester, Chatham and Maidstone. The Medway Towns alone have a population of over 225,000.

Both junctions 4 & 5 of the M2 are approximately 2.5 miles away, providing further links to the M20 and M25. Rainham train station is nearby and provides direct rail access into London in approximately 50 minutes.

DESCRIPTION

The site totals 2.07 acres and has most recently been used for automotive uses. The site may be suitable for alternative uses, subject to planning. Planning enquiries should be directed to Swale Borough Council Planning department.

SPECIFICATION

- Freehold
- A sale of part may be considered
- Redevelopment potential, subject to planning
- 2.07 acres / 0.84 hectares
- Prominent site with frontage to the A2

SALE TERMS

Offers invited for the freehold of the site.
Price on application.

BUSINESS RATES

Available upon request.

PLANNING

The site may be suitable for alternative uses, subject to planning. In the first instance, enquiries should be directed to Swale Borough Council Planning department on 01795 424341

LEGAL COSTS

Each party will be responsible for their own legal costs incurred in this transaction.



0207 344 6730

colliers.com/uk/industrial

Tim Harding:
Phone: 07860 180 328
Email: tjm.harding@colliers.com

Anthony Keohane:
Phone: 0 7785 253058
Email: anthony.Keohane@colliers.com



Kevin Dempster:
Phone: 01634 668 0000
Email: kevindempster@watsonday.com

Misrepresentation Act

Colliers International gives notice that these particulars are set out as a general outline only for the guidance of intending Purchasers or Lessees and do not constitute any part of an offer or contract. Details are given without any responsibility and any intending Purchasers, Lessees or Third Party should not rely on them as statements or representations of fact, but must satisfy themselves by inspection or otherwise as to the correctness of each of them. No person in the employment of Colliers International has any authority to make any representation or warranty whatsoever in relation to this property. 17/05/2019

Colliers International is the licensed trading name of Colliers International Property Consultants Limited. Company registered in England & Wales no. 7996509. Registered office: 50 George Street, London W1U 7GA

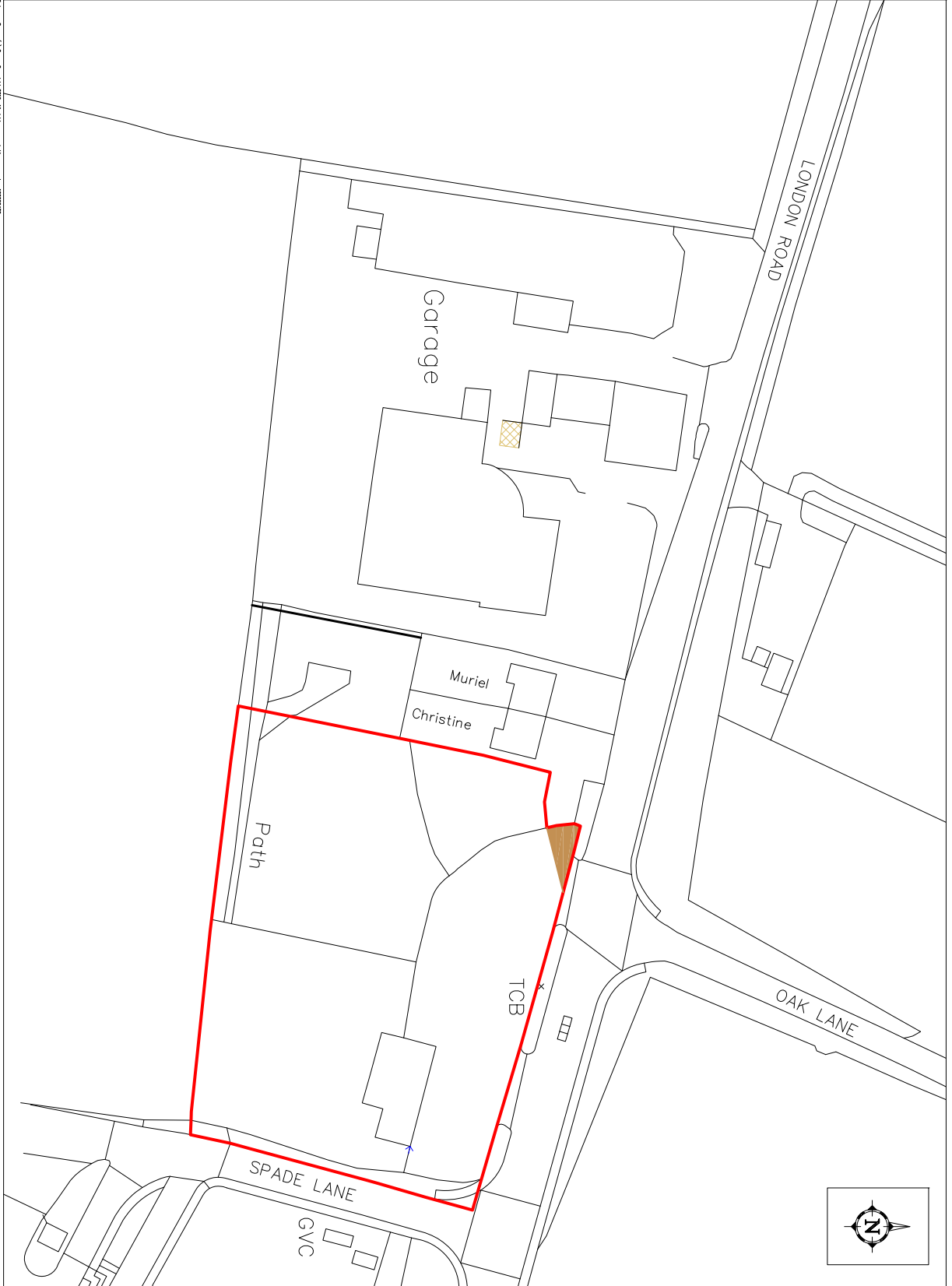

© Crown Copyright 2018. All rights reserved. Licence number 100020242

LOCATION PLAN



Trueplan 
Trueplan (UK) Ltd
Mount Pleasant House
2-4 Lonsdale Gardens
Tunbridge Wells
Kent TN1 1HJ

Land survey PLOT D
London Road, Rainham, Kent, ME8 8PT

Scale 1:1250 @A4
Drawing no: 40001
Drawn on: 14/08/2020
Revision 0